



---

## FAUX WOOD BEAMS INSTALLATION

---

### HDF INTERIOR "U" SHAPED BEAMS

- ✓ Start with clean, sound substrate; if applying over a painted surface make sure that the paint is load bearing. Figure out the desired layout for all beams. Mark the inside dimension of each beam on the ceiling at each end and one mark in the center of the room. Chalk lines for each inside dimension of the beam or pencil a line using a long straight edge.

Using a 3/32" drill bit, pre-drill holes 24" on center through the 2" x 2" KD nailing strips.

- ✓ Place nailing strip on the inside of the chalk line and re-drill through each hole to mark the spot to accept the drywall anchor. Pull the nailing strip down and screw in the drywall anchors. Apply a 1/4" continuous bead of PL Premium® Polyurethane Construction Adhesive to the back side of the nailing strip. Place the nailing strip back on the ceiling and attach with 3-1/8" GRK R4 #9 multipurpose screws that screw into the drywall anchors. 2" x 6" (minimum length of 12") KD wood blocks are also approved for the installation of beams. They should be spaced 36" on center at a minimum. Pre-drill 2 holes (4 holes for larger beams) in each block and use the same application technique for the nailing strips.
- ✓ Measure the distance on the ceiling for the beam to be cut. We recommend that a 1/4" is added to the length cut. Most walls are not square and the beam can always be sanded or shaved to the exact size.
- ✓ Most beams from the factory are not square at each end. Square up one end then measure and mark for length. Using a framing square, draw a line on the 3 sides of the beam to be cut. Use a standard wood hand saw and slowly cut through the beam. If the beam was fabricated – watch for the screws that were used to manufacture the beam.
- ✓ Dry fit beam in place over 2x material.
- ✓ Pull beam back down and apply adhesive too the sides of the 2" x 2" nailing strip or 2x blocking.
- ✓ Reinstall beam and fasten with GRK #9 Kameleon finish screws 24" on center (minimum) and inbed the screw 1/16" – 1/8" below the surface of the beam. An air powered finish nailer with finish nails is also acceptable if the beam is 2 lbs per L/F.



## FAUX WOOD BEAMS INSTALLATION

### INSTALLATION RECOMMENDATION FOR HDF BEAMS

Glue & screw All  
Blocking and Nailing  
Strip to Drywall

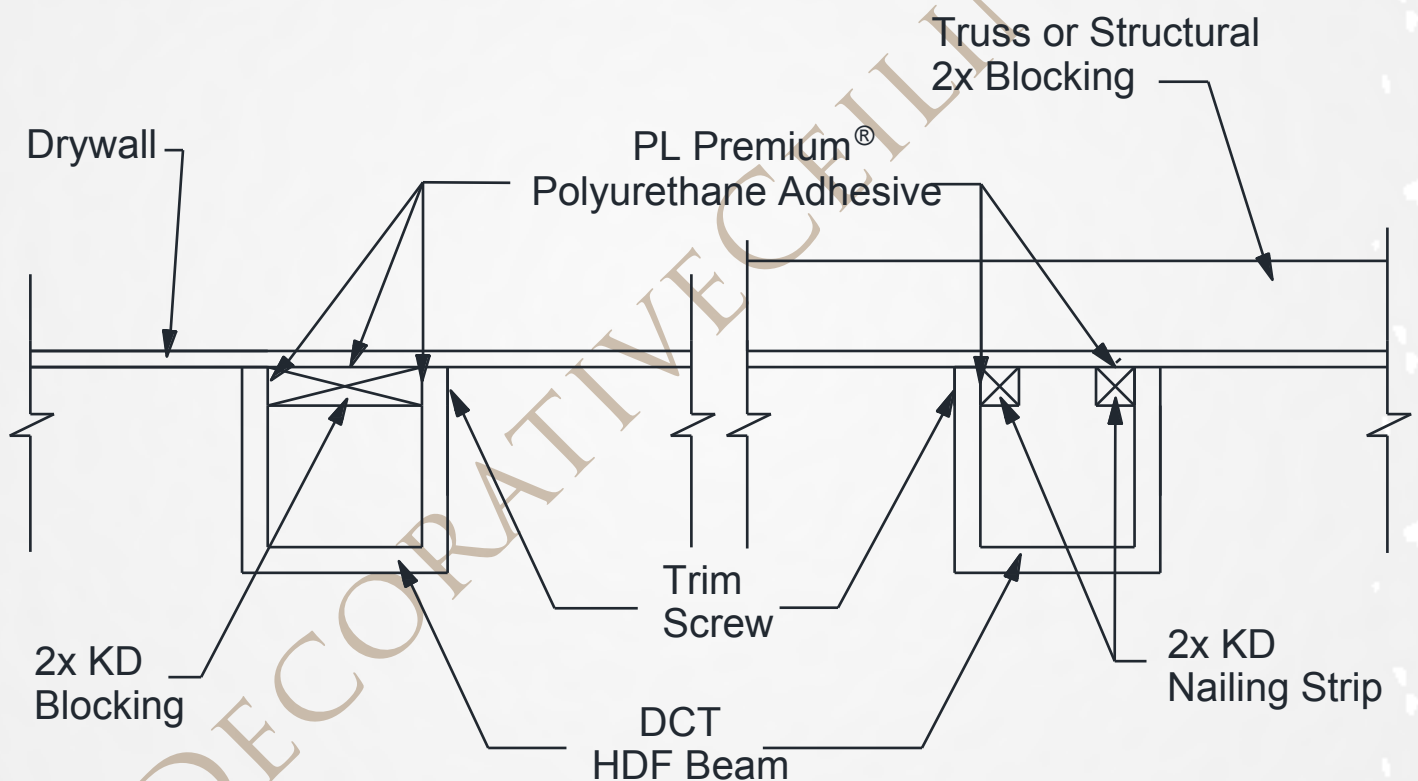

HDF Beams which weigh more than 3.25 lbs per L/F - cleating, blocking or nailing strip shall be glued, screwed and mechanically fastened to structural members - check local codes before installing beams. Distance between blocking not to exceed DCT's written recommended span for HDF Beams - typical is 2" x 6" @ 24" on center. Nailing strip to be continuous.



## FAUX WOOD BEAMS INSTALLATION

### INSTALLATION RECOMMENDATION FOR INTERSECTING HDF BEAMS

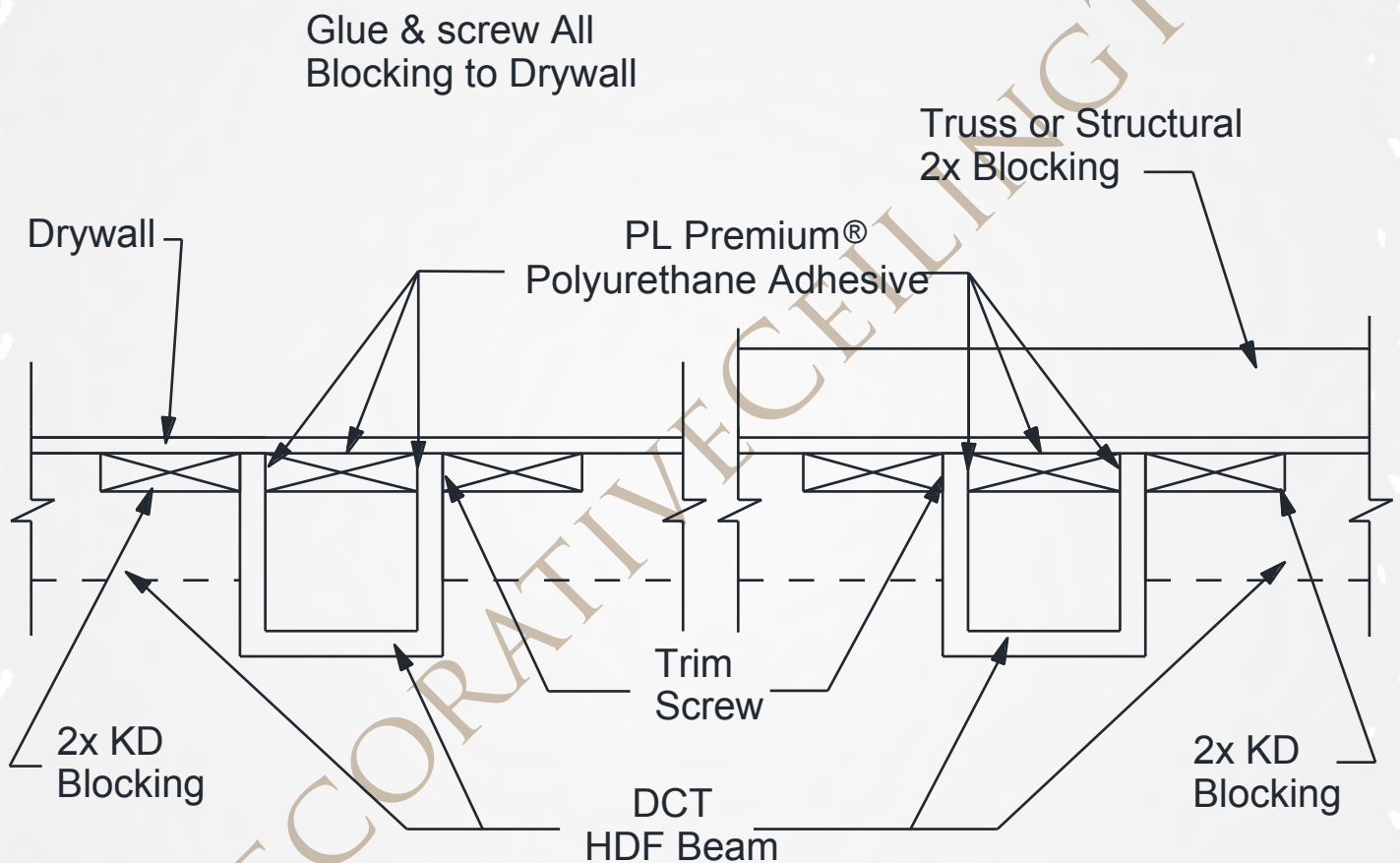

HDF Beams which weigh more than 3.25 lbs per L/F - cleating or blocking shall be glued, screwed and mechanically fastened to structural members—check local codes before installing beams. Distance between blocking not to exceed DCT's written recommended span for HDF Beams - typical is 2" x 6" @ 24" on center.



## FAUX WOOD BEAMS INSTALLATION

### INSTALLATION RECOMMENDATION FOR SUSPENSION OF HDF BEAM

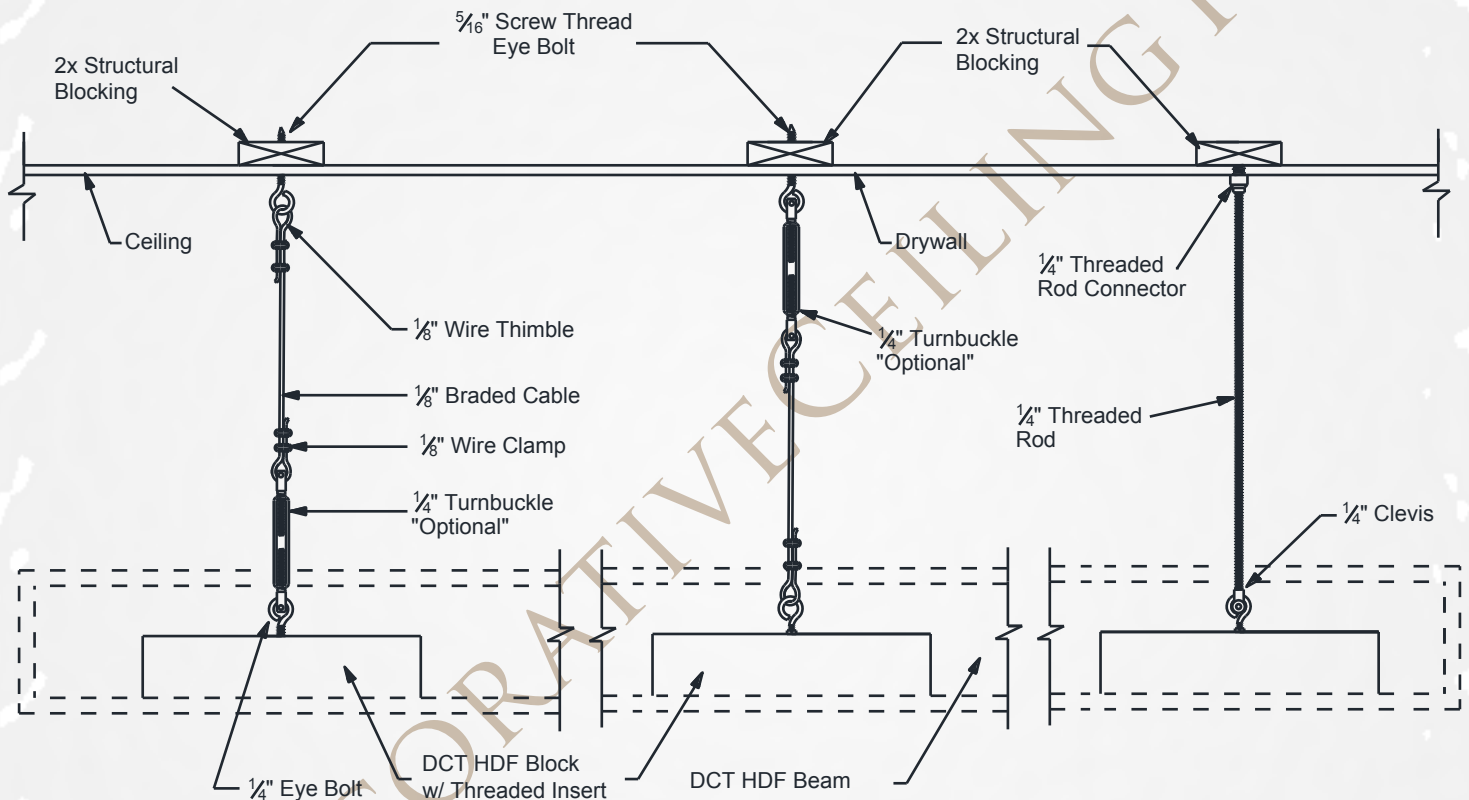

**All blocking shall be mechanically fastened to structural members—check local codes before installing beams. Distance between blocking not to exceed DCT's written recommended span for HDF Beams.**



# DECORATIVE CEILING TILES

*"from plain to beautiful in hours."*

## FAUX WOOD BEAMS INSTALLATION

### DRYWALL CEILING APPLICATION

**STEP  
01**



Layout spacing and chalk or pencil a straight line of where beams will go. make sure the line is referenced for the inside of the beam.

**STEP  
02**



Apply 2x blocking with urethane adhesive and screws.

**STEP  
03**



Apply 2x blocking with urethane adhesive and screws.

**STEP  
04**



Cut beam to size and "Dry Fit" into place before attaching with glue and nails.



# DECORATIVE CEILING TILES

*"from plain to beautiful in hours."*

## FAUX WOOD BEAMS INSTALLATION

### DRYWALL CEILING APPLICATION

**STEP  
05**



Cut beam to size and "Dry Fit" into place before attaching with glue and nails.

**STEP  
06**



Apply urethane adhesive to blocking.

**STEP  
07**



Fit beam into place after applying adhesive.

**STEP  
08**



Finish the install by shooting a few "brad nails" or finish nails into the side of the beam.



# DECORATIVE CEILING TILES

*"from plain to beautiful in hours."*

## FAUX WOOD BEAMS INSTALLATION

### DRYWALL CEILING APPLICATION

STEP  
09



STEP  
10

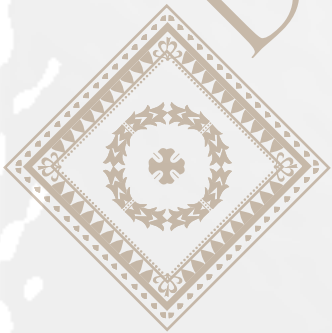



## FR-HDF BEAM INSTALLATION

### RECOMMENDATION FOR STRUCTURAL I BEAM

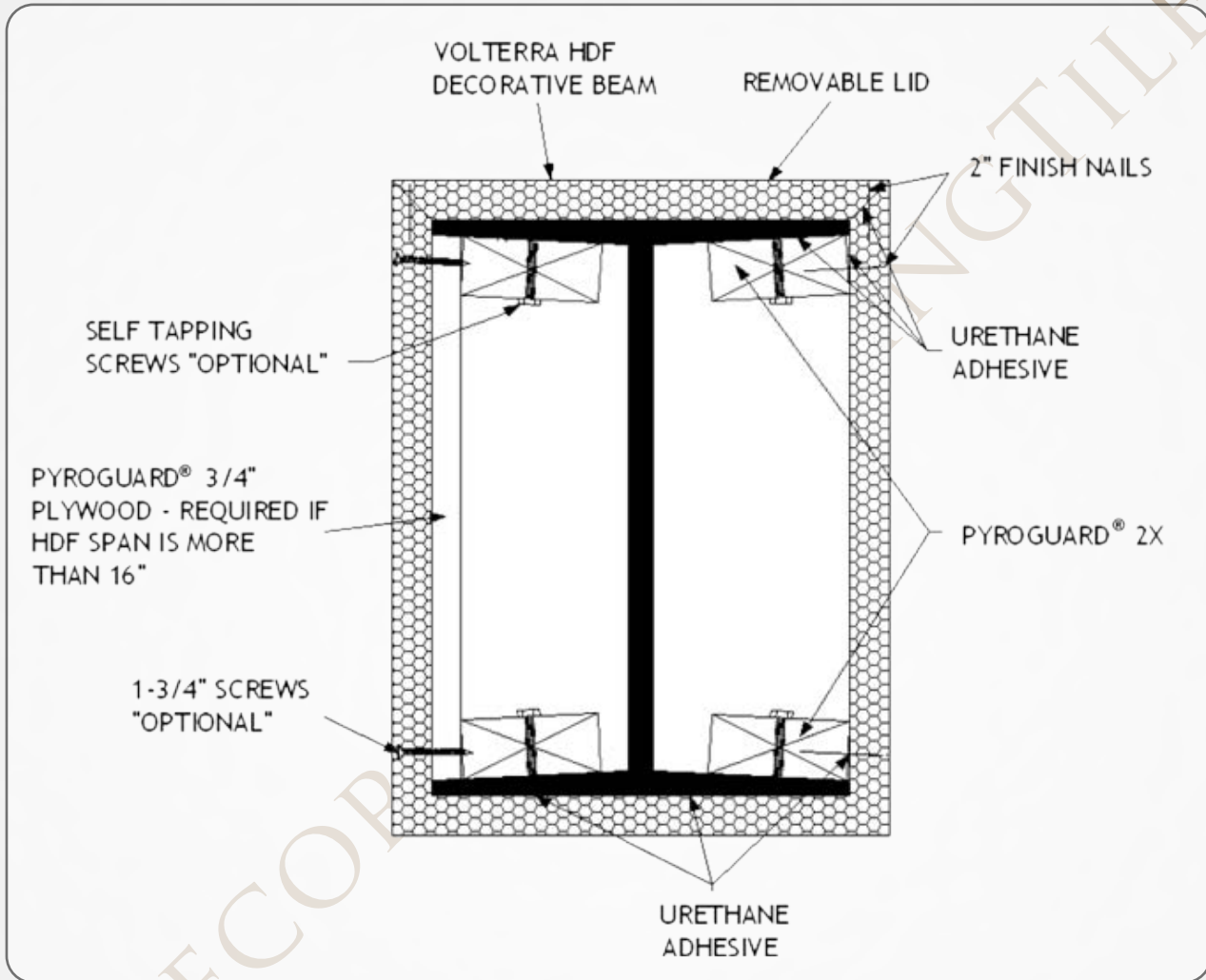

\* FR-HDF is manufactured with a resin which passes ASTM-E84 and meets Class A Criteria \*

- ✓ Clean steel with appropriate solvent where HDF beam and the 2X will be adhered
- ✓ Apply urethane adhesive to 2X and steel then mechanically fasten or clamp and let dry
- ✓ Apply urethane adhesive to the inside of beam and 2X—press firmly into place then fasten with finish nails or screws
- ✓ Apply urethane adhesive to top of I beam and fasten HDF Lid with finish nails